

VI TELEFILTER**Filter specification****TFS 70H41****1/5****Measurement condition**

Ambient temperature:	25	°C
Input power level:	0	dBm
Terminating impedance: *		
input:	410 Ω //	-12,0 pF
output:	610 Ω //	- 9,6 pF

Characteristics**Remark:**

The reference level for the relative attenuation a_{rel} of the TFS 70H41 is the minimum of the pass band attenuation a_{min} . The minimum of the pass band attenuation a_{min} is defined as the insertion loss a_e . The centre frequency f_c is the arithmetic mean value of the upper and lower frequencies at the 3 dB filter attenuation level relative to the insertion loss a_e . The temperature coefficient of frequency TC_f is valid for both the reference frequency f_c and the frequency response of the filter in the operating temperature range. The frequency shift of the filter in the operating temperature range is not included in the production tolerance scheme.

D a t a		typ. value		tolerance / limit		
Insertion loss (reference level)	a_e	21,8	dB	max.	23	dB
Centre frequency	f_c	-			70,0 \pm 0,20	MHz
Passband	PB				$f_c \pm 11$	MHz
Bandwidth	BW					
1 dB		21,09	MHz	min.	20,6	MHz
3 dB		22,84	MHz	min.	22,0	MHz
40 dB		27,78	MHz	max.	28,2	MHz
Relative attenuation	a_{rel}					
f_c	\pm 9,4 MHz	0,6	dB	max.	0,8	dB
$f_c \pm$ 9,4 MHz	\pm 10,3 MHz	0,6	dB	max.	1	dB
$f_c \pm$ 10,3 MHz	\pm 11 MHz	2	dB	max.	3	dB
$f_c \pm$ 14,1 MHz	\pm 27 MHz	45	dB	min.	40	dB
$f_c \pm$ 27 MHz	\pm 60 MHz	60	dB	min.	55	dB
Group delay ripple within PB		45	ns	max.	60	ns
Phase ripple within PB		4,5	°	max.	6	° p-p
Operating temperature range	OTR	-			- 25 °C ... + 80 °C	
Storage temperature range		-			- 40 °C ... + 85 °C	
Temperature coefficient of frequency	TC_f **	-83	ppm/K		-	

*) The terminating impedances depend on parasitics and q-values of matching elements and the board used, and are to be understood as reference values only. Should there be additional questions do not hesitate to ask for an application note or contact our design team.

**) $\Delta f(\text{Hz}) = TC_f(\text{ppm/K}) \times (T - T_0) \times f_{T0}(\text{MHz})$.

Generated:**Checked / Approved:**

Tele Filter GmbH
Potsdamer Straße 18
D 14 513 TELTOW / Germany
Tel: (+49) 3328 4784-0 / Fax: (+49) 3328 4784-30
E-Mail: tft@telefilter.com

VI TELEFILTER reserves the right to make changes to the product(s) and/or information contained herein without notice. No liability is assumed as a result of their use or application. No rights under any patent accompany the sale of any such product(s) or information.

VI TELEFILTER

Filter specification

TFS 70H41

2/5

Filter characteristic

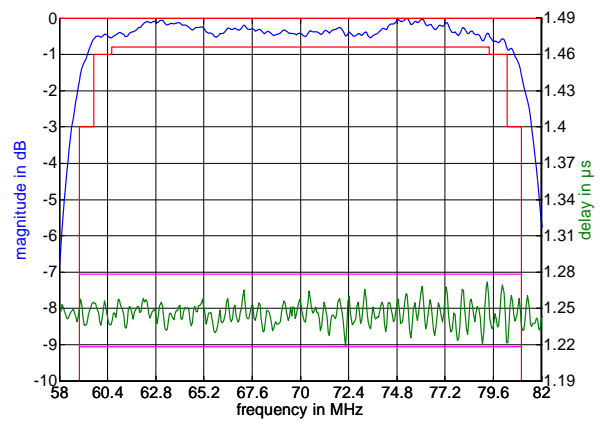
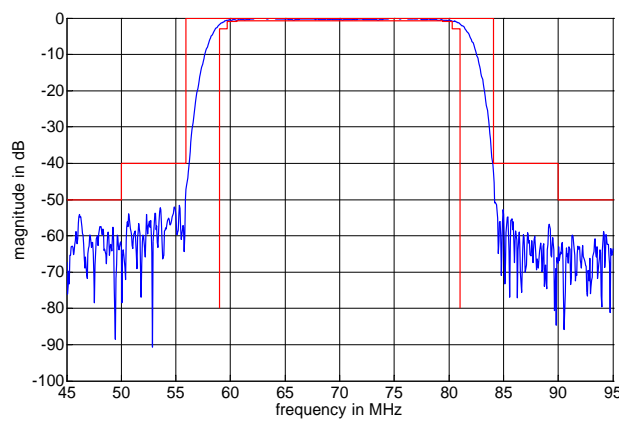

Construction and pin connection

(All dimensions in mm)

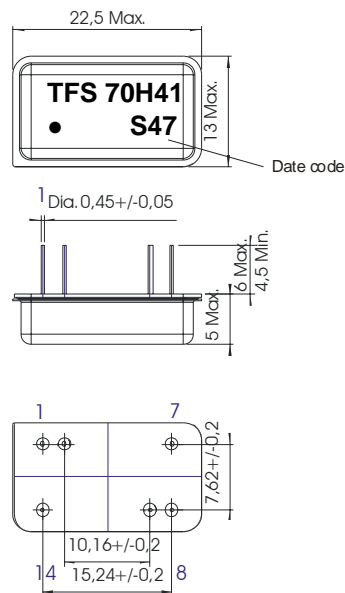

1	Input
2	Ground
7	Output RF Return
8	Output
9	Ground
14	Input RF Return

Date code: Year + week
 S 2004
 T 2005
 U 2006
 ...

50 Ohm Test circuit

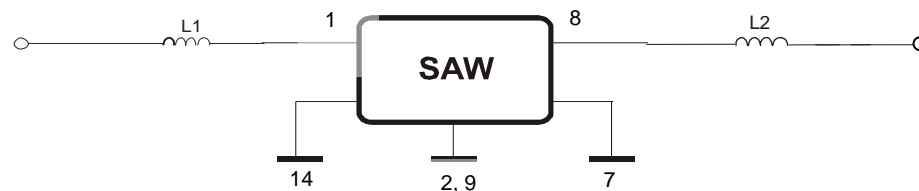

Tele Filter GmbH
 Potsdamer Straße 18
 D 14 513 TELTOW / Germany
 Tel: (+49) 3328 4784-0 / Fax: (+49) 3328 4784-30
 E-Mail: tft@telefilter.com

VI TELEFILTER reserves the right to make changes to the product(s) and/or information contained herein without notice. No liability is assumed as a result of their use or application. No rights under any patent accompany the sale of any such product(s) or information.

Stability characteristics :

After the following tests the filter shall meet the whole specification:

1. Shock: 500g, 18 ms, half sine wave, 3 shocks each plane;
DIN IEC 68 T2 - 27
2. Vibration: 10 Hz to 500 Hz, 0,35 mm or 5g respectively, 1 octave per min, 10 cycles per plan, 3 plans;
DIN IEC 68 T2 - 6
3. Change of temperature: -55 °C to 125°C / 30 min. each / 10 cycles
DIN IEC 68 part 2 – 14 Test N
4. Resistance to solder heat (reflow): reflow possible: twice max.;
for temperature conditions refer to the attached "Air reflow temperature conditions" on page 4;

Air reflow temperature conditions

Conditions	Exposure
Average ramp-up rate (30°C to 217°C)	less than 3°C/second
> 100°C	between 300 and 600 seconds
> 150°C	between 240 and 500 seconds
> 217°C	between 30 and 150 seconds
Peak temperature	max. 260°C
Time within 5°C of actual peak temperature	between 10 and 30 seconds
Cool-down rate (Peak to 50°C)	less than 6°C/second
Time from 30°C to Peak temperature	no greater than 300 seconds

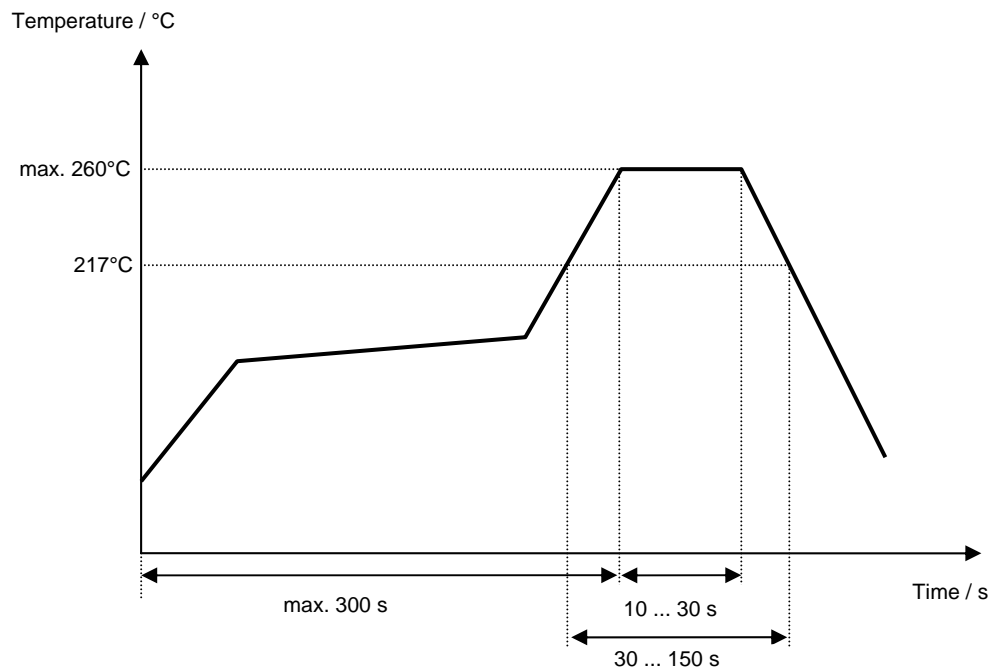
Chip-mount air reflow profile

VI TELEFILTER**Filter specification****TFS 70H41****5/5****History**

Version	Reason of changes	Name	Date
1.0	- filter specification created	Pfeiffer	13.07.2004
1.1	- terminating impedance, typical values, matching configuration and filter characteristic added - limits of group delay ripple, phase ripple and relative attenuation modified	Pfeiffer	09.08.2004
1.2	- limits of centre frequency corrected	Pfeiffer	16.11.2004

Tele Filter GmbH
Potsdamer Straße 18
D 14 513 TELTOW / Germany
Tel: (+49) 3328 4784-0 / Fax: (+49) 3328 4784-30
E-Mail: tft@telefilter.com

VI TELEFILTER reserves the right to make changes to the product(s) and/or information contained herein without notice. No liability is assumed as a result of their use or application. No rights under any patent accompany the sale of any such product(s) or information.