

VI TELEFILTER**Filter specification****TFS 433H****1/5****Measurement condition**

Ambient temperature:	23	°C
Input power level:	0	dBm
Terminating impedance:		
Input:	50	Ω
Output:	50	Ω

Characteristics

Remark:

The reference level for the relative attenuation a_{rel} of the TFS 433H is the minimum of the pass band attenuation a_{min} . The minimum of the pass band attenuation a_{min} is defined as the insertion loss a_e . The centre frequency f_c is the arithmetic mean value of the upper and lower frequencies at the 3 dB filter attenuation level relative to the insertion loss a_e . The nominal frequency f_N is fixed at 433,92 MHz without any tolerance. The given values for the relative attenuation a_{rel} have to be achieved at the frequencies given below even if the centre frequency f_c is shifted due to the temperature coefficient of frequency TC_f in the operating temperature range and due to a production tolerance for the centre frequency f_c .

D a t a		typ. value		tolerance / limit	
Insertion loss (reference level)	$a_e = a_{min}$	2,7	dB	max.	3,5 dB
Centre frequency	f_c	433,92	MHz	-	
Nominal frequency	f_N	-		433,92	MHz
3 dB - bandwidth		-		min.	5 MHz
Relative attenuation	a_{rel}				
$f_N \pm 25$ MHz ... $f_N \pm 100$ MHz		70	dB	min.	40 dB
$f_N \pm 100$ MHz ... $f_N \pm 200$ MHz		70	dB	min.	60 dB
$f_N - 10,7$ MHz		70	dB	min.	60 dB
Operating temperature range	OTR	-		- 15 °C ... + 60	°C
Storage temperature range		-		- 40 °C ... + 85	°C
Temperature coefficient of frequency	TC_f *	-32	ppm/K	-	

*) $\Delta f_c(\text{Hz}) = TC_f(\text{ppm/K}) \times (T - T_o) \times f_{CAT}(\text{MHz})$.

Generated:**Checked / Approved:**

Tele Filter GmbH
Potsdamer Straße 18
D 14 513 TELTOW / Germany
Tel: (+49) 3328 4784-0 / Fax: (+49) 3328 4784-30
E-Mail: tft@telefilter.com

VI TELEFILTER reserves the right to make changes to the product(s) and/or information contained herein without notice. No liability is assumed as a result of their use or application. No rights under any patent accompany the sale of any such product(s) or information.

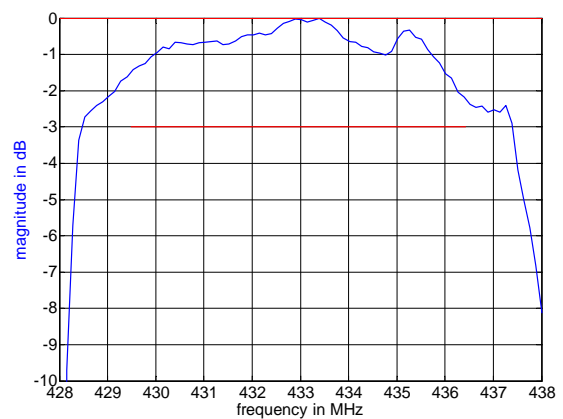
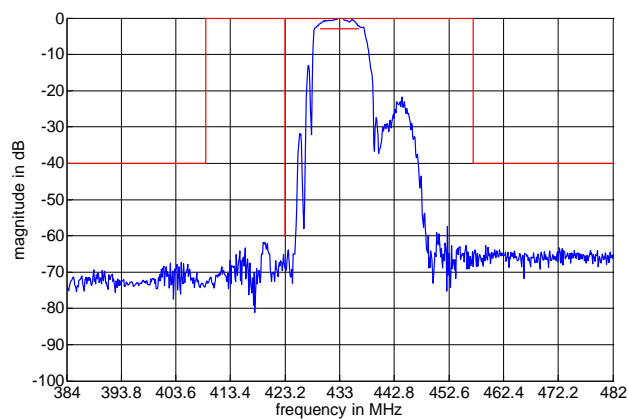
VI TELEFILTER**Filter specification****TFS 433H****2/5****Filter characteristic****Construction and pin connection**

(All dimensions in mm)

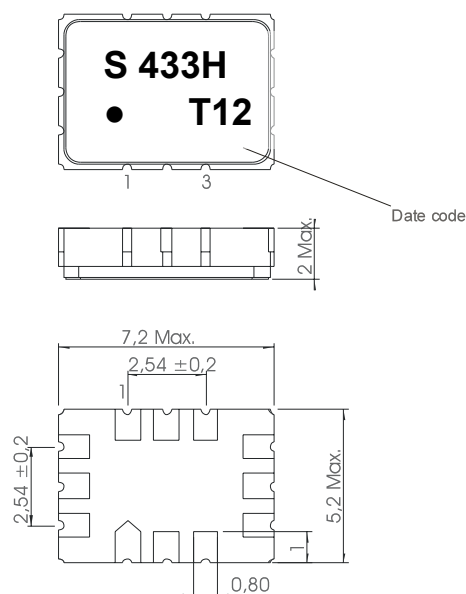

1	Ground
2	Ground
3	Ground
4	Input
5	Ground
6	Ground
7	Ground
8	Ground
9	Ground
10	Output
11	Ground
12	Ground

Date code: Year + week
 T 2005
 U 2006
 V 2007
 ...

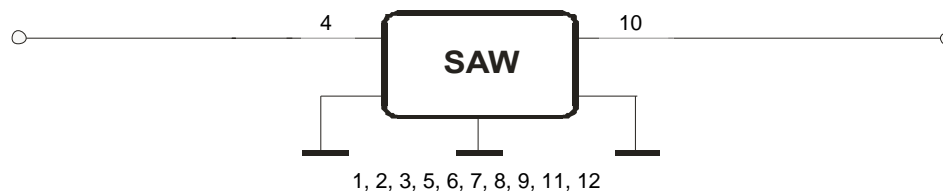
50 Ω Test circuit

Tele Filter GmbH
 Potsdamer Straße 18
 D 14 513 TELTOW / Germany
 Tel: (+49) 3328 4784-0 / Fax: (+49) 3328 4784-30
 E-Mail: tft@telefilter.com

VI TELEFILTER reserves the right to make changes to the product(s) and/or information contained herein without notice. No liability is assumed as a result of their use or application. No rights under any patent accompany the sale of any such product(s) or information.

VI TELEFILTER**Filter specification****TFS 433H****3/5****Stability characteristics**

After the following tests the filter shall meet the whole specification:

1. Shock: 500g, 1 ms, half sine wave, 3 shocks each plane;
DIN IEC 68 T2 - 27
2. Vibration: 10 Hz to 500 Hz, 0,35 mm or 5 g respectively, 1 octave per min, 10 cycles per plan, 3 plans;
DIN IEC 68 T2 - 6
3. Change of temperature: -55 °C to 125°C / 30 min. each / 10 cycles
DIN IEC 68 part 2 – 14 Test N
4. Resistance to solder heat (reflow): reflow possible: twice max.;
for temperature conditions refer to the attached "Air reflow temperature conditions" on page 4;

Packing

Tape & Reel: IEC 286 – 3, with exeption of value for N and minimum bending radius;
tape type II, embossed carrier tape with top cover tape on the upper side;

max. pieces of filters peer reel: 3000
reel of empty components at start: min. 300 mm
reel of empty components at start including leader: min. 500 mm
trailer: min. 300 mm

Tape (all dimensions in mm)

W	: 16,00 ± 0,3
Po	: 4,00 ± 0,1
Do	: 1,50 +0,1/-0
E	: 1,75 ± 0,1
F	: 7,50 ± 0,1
G(min)	: 0,60
P2	: 2,00 ± 0,1
P1	: 8,00 ± 0,1
D1(min)	: 1,50
Ao	: 5,50 ± 0,1
Bo	: 7,50 ± 0,1
Ct	: 13,5 ± 0,1

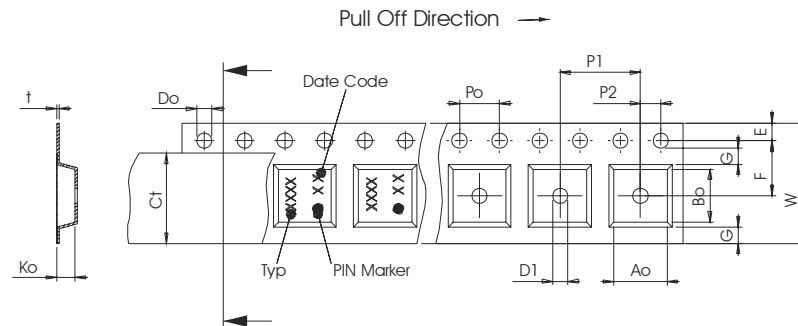
**Reel (all dimensions in mm)**

A	: 330
W1	: 16,4 +2/-0
W2(max)	: 22,4
N(min)	: 50
C	: 13,0 +0,5/-0,2

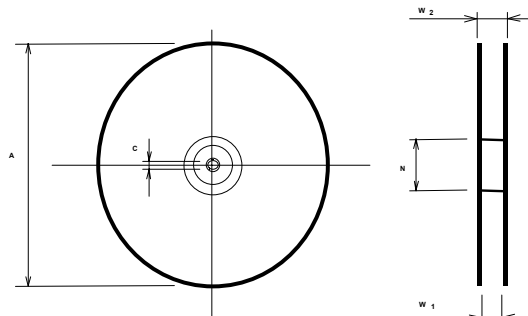

The minimum bending radius is 45 mm.

Tele Filter GmbH
Potsdamer Straße 18
D 14 513 TELTOW / Germany
Tel: (+49) 3328 4784-0 / Fax: (+49) 3328 4784-30
E-Mail: tft@telefilter.com

VI TELEFILTER reserves the right to make changes to the product(s) and/or information contained herein without notice. No liability is assumed as a result of their use or application. No rights under any patent accompany the sale of any such product(s) or information.

Air reflow temperature conditions

Conditions	Exposure
Average ramp-up rate (30°C to 217°C)	less than 3°C/second
> 100°C	between 300 and 600 seconds
> 150°C	between 240 and 500 seconds
> 217°C	between 30 and 150 seconds
Peak temperature	max. 260°C
Time within 5°C of actual peak temperature	between 10 and 30 seconds
Cool-down rate (Peak to 50°C)	less than 6°C/second
Time from 30°C to Peak temperature	no greater than 300 seconds

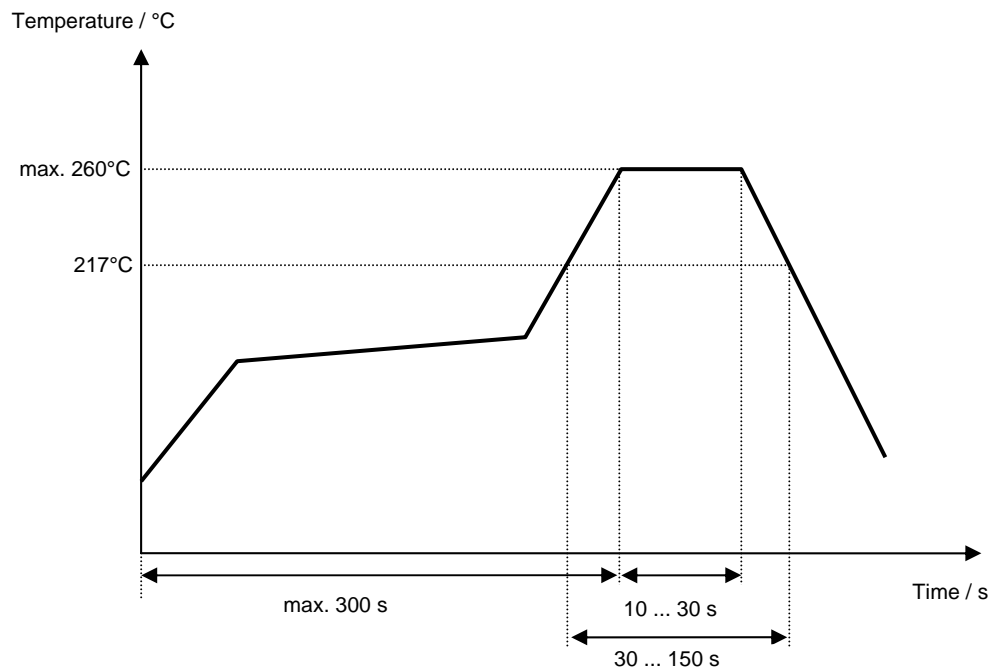
Chip-mount air reflow profile

VI TELEFILTER**Filter specification****TFS 433H****5/5****History :**

Version	Reason of Changes	Name	Date
1.0	Generate development specification	Chilla	08.10.2004
1.1	Change of TK, test circuit, filter characteristic	Martens	28.10.2004
1.2	Changed insertion loss to be measured at minimum in PB	Martens	12.11.2004
1.3	Corrected relative attenuation, changed layout	Martens	15.03.2005