

Recommended P.C.B. Layout

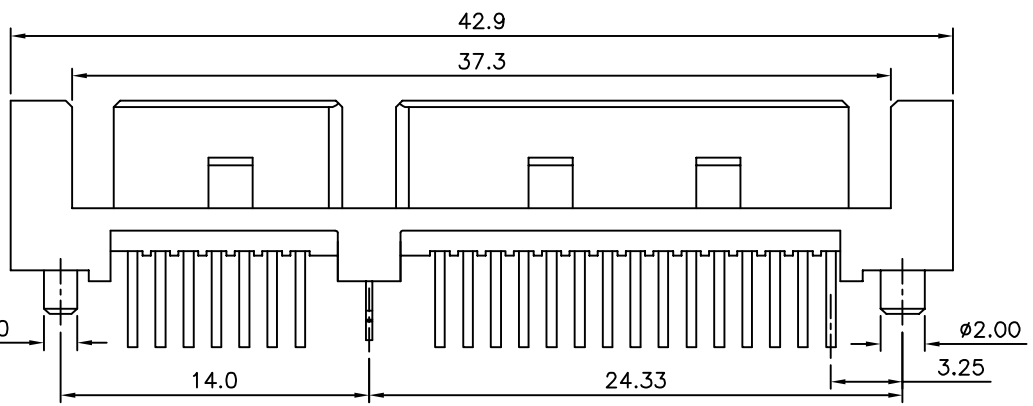
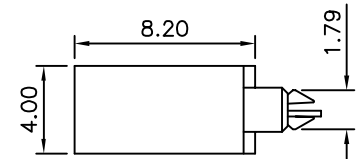
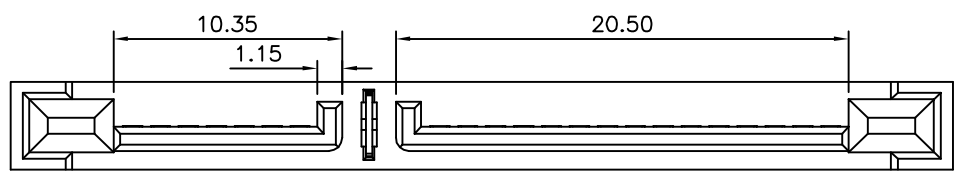
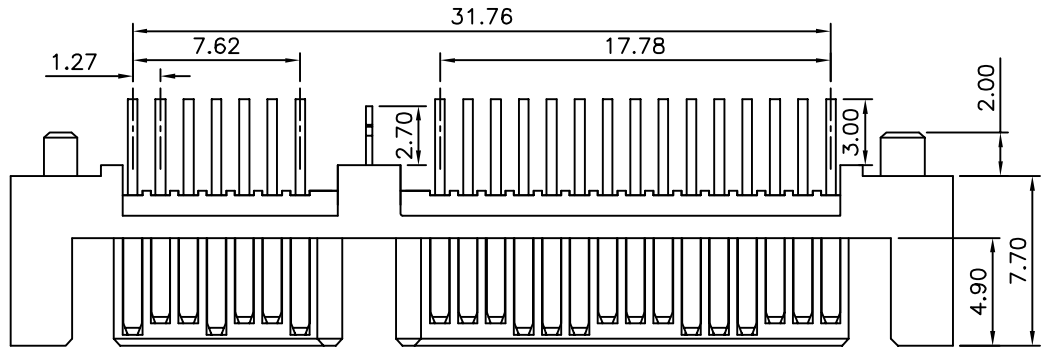

SPECIFICATION

Current Rating:1.5A
 Operation Voltage:100V AC Max.
 Withstand Voltage:500V AC
 Contact Resistance:30 Milliohms Max.
 Insulation Resistance:1000 Megaohms Min.
 Operating Temperature:-25°C~+85°C
 Housing:LCP+30%G.F.(UL94V-0),Black
 Contact:Brass
 Peg:Brass,Tin Plated On Solder Tails,Nickel Plated Over All
 RoHS Compliant

SATA 22 P D A Z - X - H H
 (1) (2) (3) (4) (5) (6) (7) (8) (9)

- (1) SATA:Serial ATA Series
- (2) 22:7+15 Pin
- (3) P:Male
- (4) D:DIP Straight
- (5) A:Single Contact
- (6) Z:With Boardlock
- (7) X:Contact Finish
 Blank:Gold Flash On Contact Area,Tin Plated On Solder Tails,Over Nickel
 3:Gold Plated 15u" On On Contact Area,Tin Plated On Solder Tails,Over Nickel
- (8) H:Withstand High Temperature Soldering
- (9) H:RoHS Compliant

AUK A MEMBER OF AUK GROUP
太聯事業股份有限公司
AUK CONTRACTORS CO., LTD.

CATEGORY		APPROVED BY		UNLESS OTHERWISE SPECIFIED TOLERANCES ARE X. ±0.25 X.* ±2" .X ±0.20 .X* ±1.5" .XX ±0.15 .XX* ±1" .XXX ±0.10 .XXX* ±0.5"
PART No. SATA22PDAZ-X-HH		EMILY		
DRAWING No. SATA22PDAZ-X-HH		CHECKED BY HZF		
SCALE NONE		DRAWING BY SONG		
REV.	A0	UNIT mm	NO. REV.	

NEW RELEASE		HZF		05/14/2013	
REVISIONS		CHK		DATE	