

REV.	DESCRIPTION	DRAWN	CHECKED	APPROVED
A	NEW RELEASE	LL 07/01/06'		

R/A TYPE

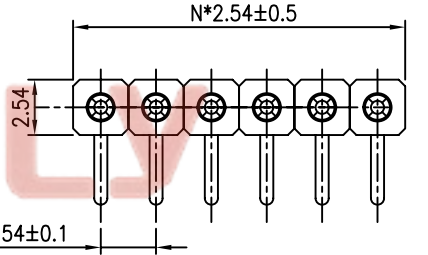

SMT TYPE

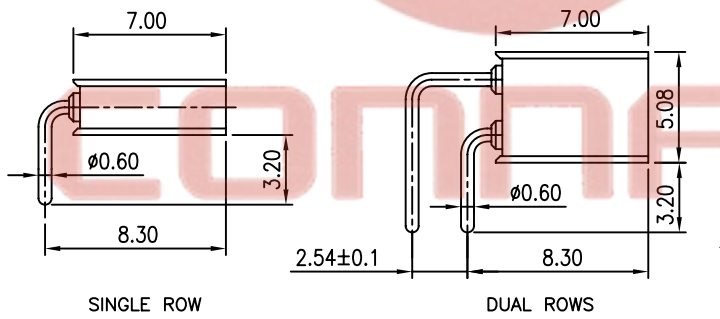
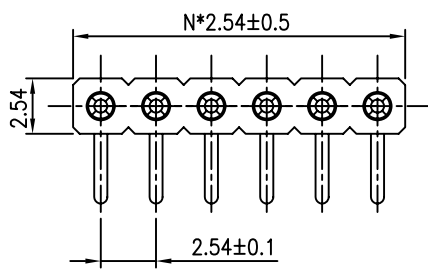
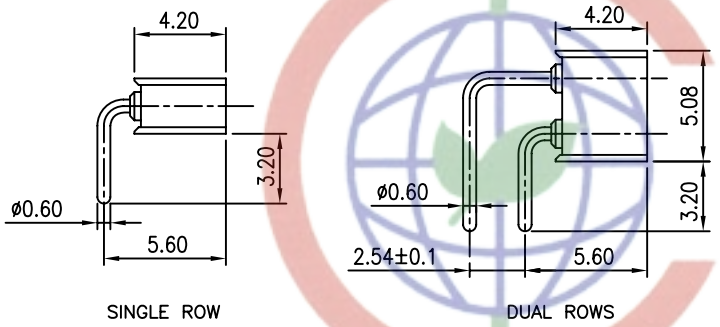
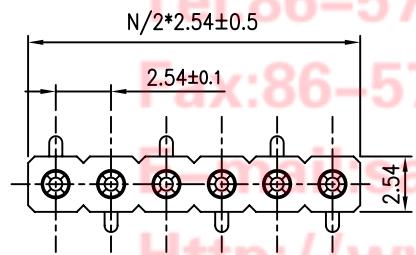
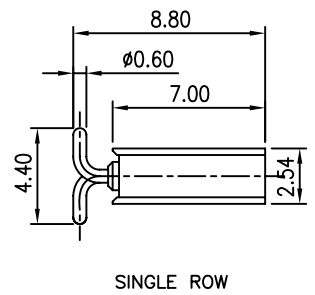
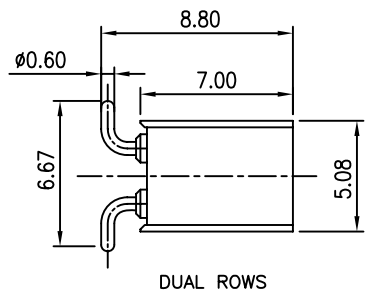

NOTES:

- ELECTRICAL:
 - Current rating: 3Amps/contact max.
 - Contact resistance: $\leq 20m\Omega$ /contact.
 - Insulation resistance: $\geq 1000M\Omega$ at $V=100V$.
 - Operating voltage: 60V AC/DC.

2. PRODUCT NUMBER CODE:

DS1002-08 - X X X X X

- Profile height
 - 420: 4.20mm
 - 700: 7.00mm
- CLIP PLATING OPTION
 - 1: Tin 150u"
 - 2: Tin 200u"
 - 3: G/F
 - 4: Gold 3u"
 - 5: Gold 10u"
 - 6: Gold 15u"
- PIN PLATING OPTION
 - 1: Tin 150u"
 - 2: Tin 200u"
 - 3: G/F
 - 4: Gold 3u"
 - 5: Gold 10u"
 - 6: Gold 15u"
- MOUNTING TYPE
 - R: R/A TYPE
 - S: SMT TYPE
- No. OF CONTACTS
 - 1*1 to 1*40
 - 2*2 to 2*40
- SERIES NO
 - DS1002-08

GENERAL TOLERANCE		ANGLE TOLERANCE	
X.	±0.60	X.	±5°
.X	±0.38	.X	±3°
.XX	±0.25	.XX	±2°

DRAWING TYPE	CUSTOMER		
SCALE	1:1	SHEET	10F1
DRAWING NO.	C-DS1002-08-XXXXX		

PROJECTION		TITLE	SMT & R/A IC SOCKET PITCH 2.54mm
UNITS	mm		MATING PIN Ø0.47
SHEET SIZE	A4	SERIES	DS1002-08 SERIES

晨翔电子有限公司
CONNFLY CONNFLY ELECTRONIC CO. LTD

Tel: 86-574-63508787
Fax: 86-574-63510817
Email: sales@zhenqin.com.cn
Http://www.connfly.com