

**SPECIFICATIONS**  
 Current Rating: 5.0A AC,DC  
 Voltage Rating: 250V AC,DC  
 Contact Resistance: 10 Milliohms Max.  
 Insulation Resistance: 1000 Megohms Min.  
 Withstanding Voltage: 1500V AC/Minute  
 Operating Temperature: -25°C To +85°C  
 Insulator: High Temp. Plastic, UL 94V-0  
 Contact: Copper Alloy  
 Plating: Tin Plated  
 RoHS Compliant

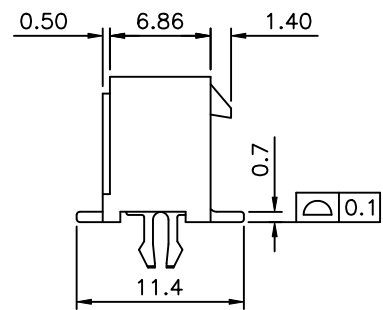
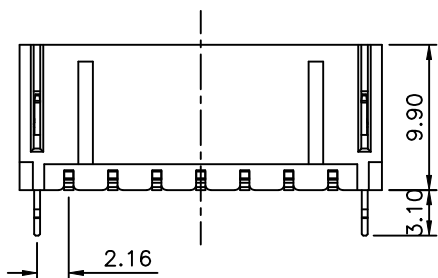
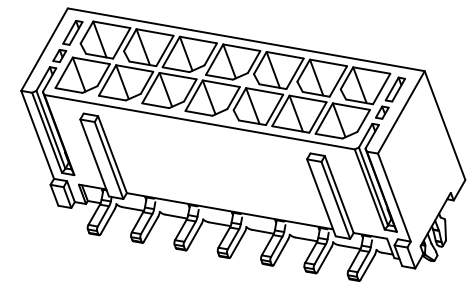
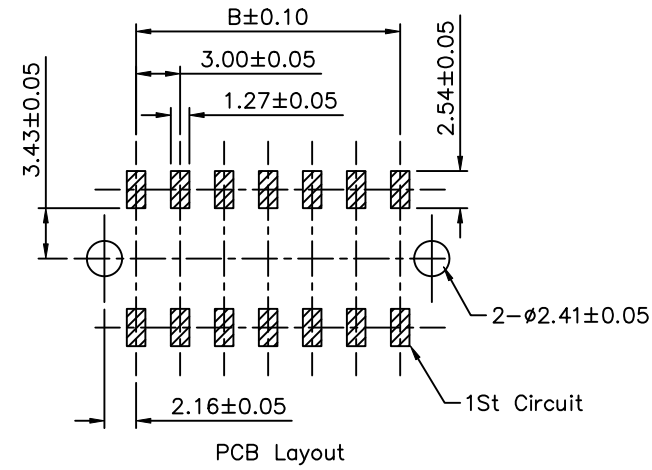
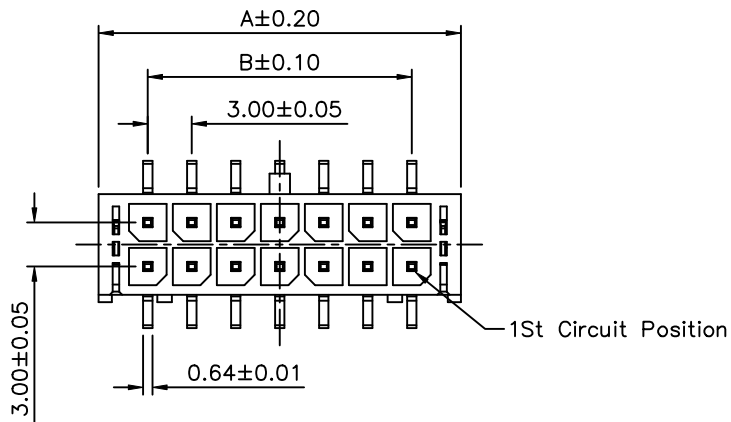

Circuits	Dim. A	Dim. B
02	6.7	---
04	9.7	3.0
06	12.7	6.0
08	15.7	9.0
10	18.7	12.0
12	21.7	15.0
14	24.7	18.0
16	27.7	21.0
18	30.7	24.0
20	33.7	27.0
22	36.7	30.0
24	39.7	33.0

**AUK** A MEMBER OF AUK GROUP  
**太聯事業股份有限公司**  
**AUK CONTRACTORS CO., LTD.**

CATEGORY		APPROVED BY		UNLESS OTHERWISE SPECIFIED TOLERANCES ARE .X ±0.2 .XX ±0.15 ANG.
PART No. MIF2XXXPVZ-H		MEI		
DRAWING No. MIF2XXXPVZ-H		SHIN		
SCALE		HZF		
NONE	REV.	A1		UNIT mm

NO.	REV.	REVISIONS	CHK	DATE
△ A1		Add Pin Mark	HZF	05/14/2008
△ A0		NEW RELEASE	SHIN	11/15/2007

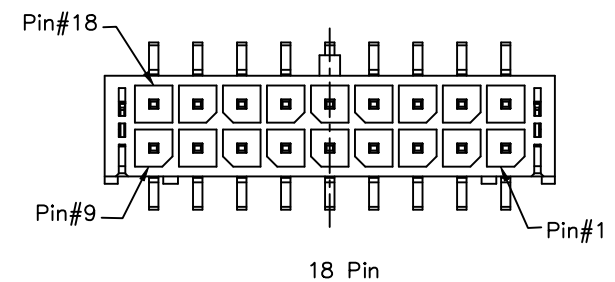
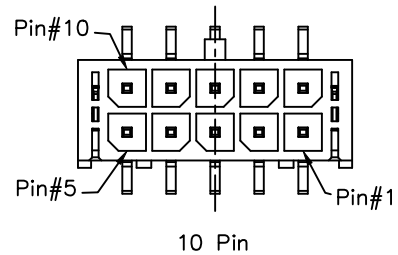
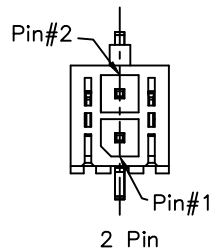
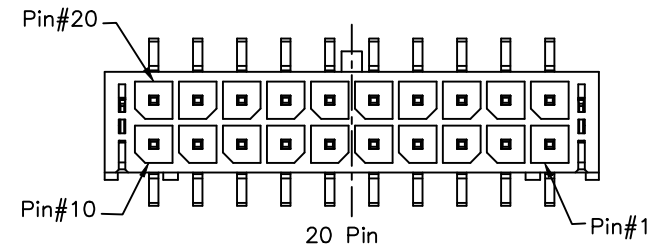
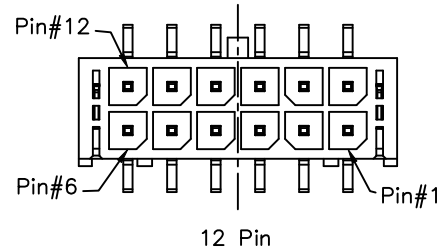
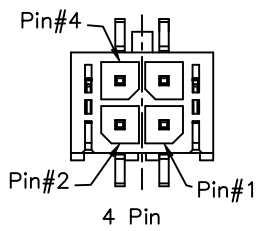
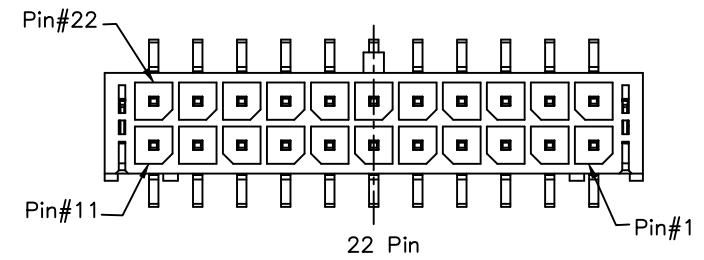
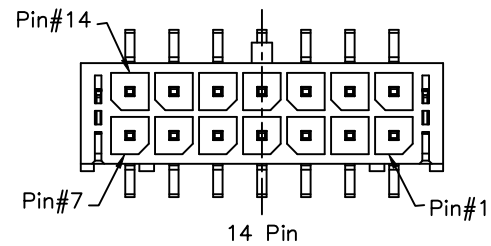
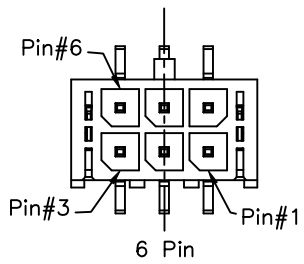
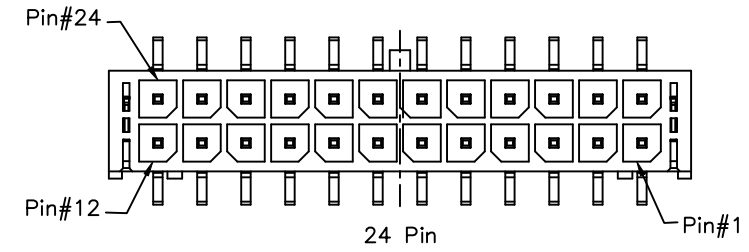
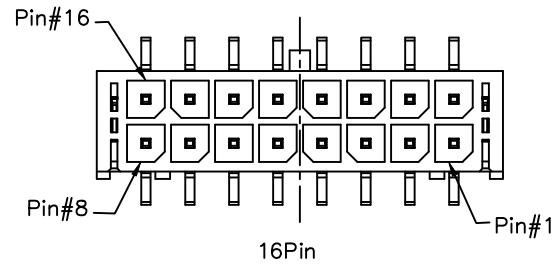
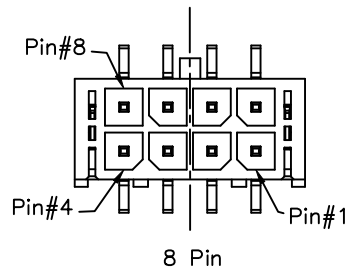

**AUK** A MEMBER OF AUK GROUP  
**太聯事業股份有限公司**  
**AUK CONTRACTORS CO., LTD.**

CATEGORY		APPROVED BY		UNLESS OTHERWISE SPECIFIED TOLERANCES ARE .X ±0.2 .XX ±0.15 ANG.
PART No. MIF2XXXPVZ-H		MEI		
DRAWING No. MIF2XXXPVZ-H		SHIN		
SCALE		REV.		
NONE		A1		UNIT mm

CHECKED BY		DRAWING BY		NO. REV.	
SHIN		HZF		A1	
A1		Add Pin Mark		HZF 05/14/2008	
A0		NEW RELEASE		SHIN 11/15/2007	
REVISIONS		CHK		DATE	