

SPECIFICATION

Current Rating:3A AC/DC
 Voltage Rating:150V AC/DC
 Withstanding Voltage:1000V AC/Minute
 Contact Resistance:10 Milliohms Max.
 Insulation Resistance:500 Megaohms Min.
 Operation Temperature:-25°C~+85°C
 Insulator:PA66+15%G.F.(UL94V-0)
 RoHS Compliant

MCG XX H - H
 (1) (2) (3) (4)

- (1) MCG:2.54 MCG Series
- (2) XX:No. Of Position
- (3) H:Female Housing
- (4) H:RoHS Compliant

Latch And Polarization Rib Location

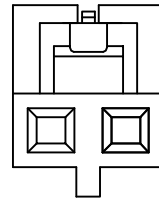

2P

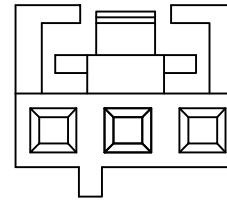

3P

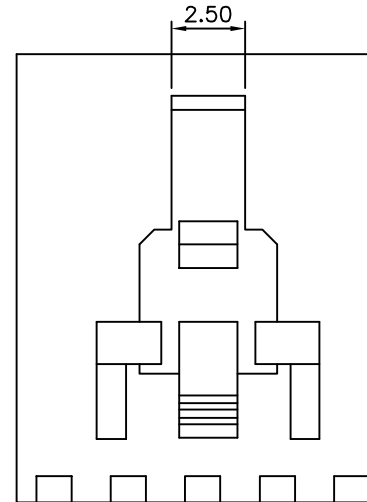
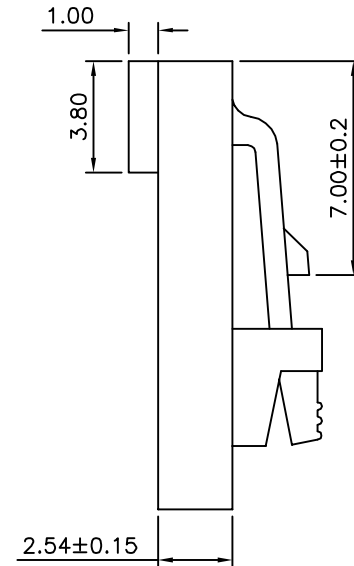
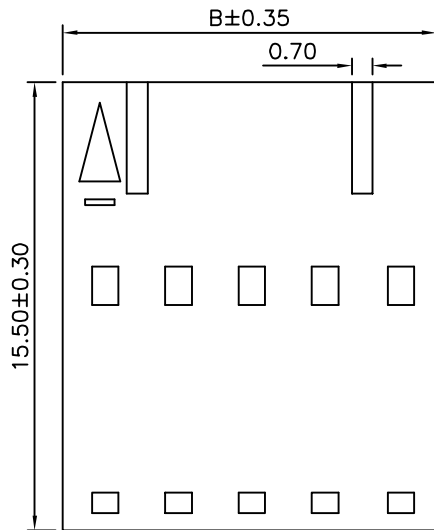
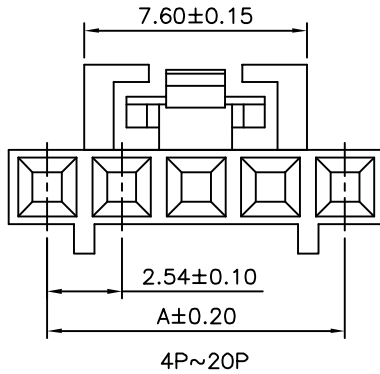

Pin	A	B
02	2.54	5.08
03	5.08	7.62
04	7.62	10.16
05	10.16	12.70
06	12.70	15.24
07	15.24	17.78
08	17.78	20.32
09	20.32	22.86
10	22.86	25.40
11	25.40	27.94
12	27.94	30.48
13	30.48	33.02
14	33.02	35.56
15	35.56	38.10
16	38.10	40.64
17	40.64	43.18
18	43.18	45.72
19	45.72	48.26
20	48.26	50.80

CATEGORY		APPROVED BY	
PART No. MCGXXH-H		MEI	
DRAWING No. MCGXXH-H		CHECKED BY HZF	
SCALE NONE		DRAWING BY SONG	
REV.	A0	UNIT	mm

UNLESS OTHERWISE SPECIFIED TOLERANCES ARE
 X. ±0.30
 .X ±0.25
 .XX ±0.20
 .XXX ±0.015

NO.	REV.	REVISIONS	CHK	DATE
△ A0		NEW RELEASE	HZF	10/03/2012