

**SPECIFICATION**

Current Rating: 3A AC/DC  
 Voltage Rating: 250V AC/DC  
 Temperature Range: -25°C~+85°C  
 Contact Resistance: 20 Milliohms Max.  
 Insulation Resistance: 1000 Megaohms Min.  
 Withstanding Voltage: 800V AC/Minute  
 Pin: Brass, Tin Plated Over Nickel  
 Insulator: PA66+15%G.F.(UL94V-0), Gray  
 RoHS Compliant

PHD XX R - H

(1) (2) (3) (4)

- (1) PHD: 2.0mm PHD Series
- (2) XX: No. Of Position
- (3) R: DIP Right Angle
- (4) H: RoHS Compliant

Pin	A	B
4	6.00	2.00
6	8.00	4.00
8	10.00	6.00
10	12.00	8.00
12	14.00	10.00
14	16.00	12.00
16	18.00	14.00
18	20.00	16.00
20	22.00	18.00
22	24.00	20.00
24	26.00	22.00
26	28.00	24.00
28	30.00	26.00
30	32.00	28.00
32	34.00	30.00
34	36.00	32.00
36	38.00	34.00
38	40.00	36.00
40	42.00	38.00

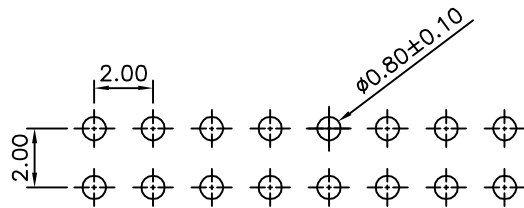

Recommended P.C.B Layout(Top Side)  
 P.C.B Thickness=1.00~1.60mm(Tolerance±0.05)

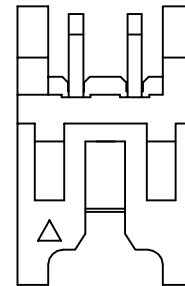
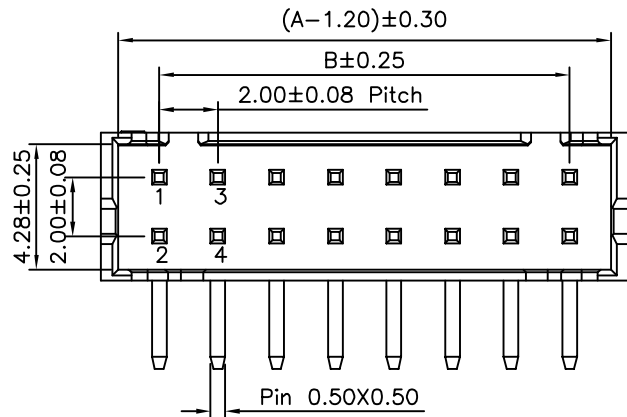
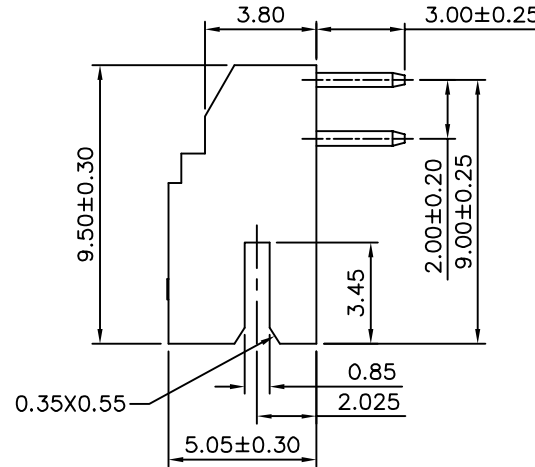
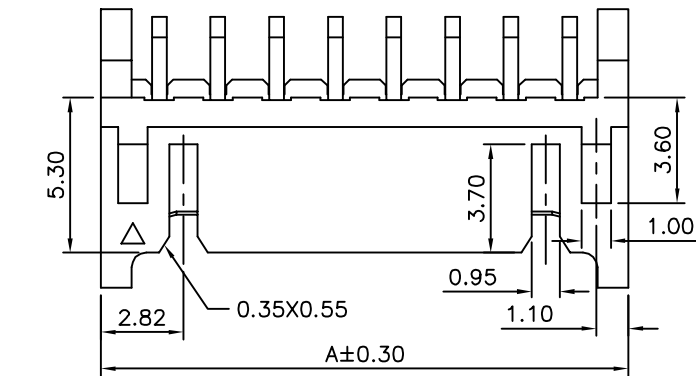

4P

CATEGORY		APPROVED BY		UNLESS OTHERWISE SPECIFIED TOLERANCES ARE XX ±0.25 .XX ±0.20 .XXX ±0.10 .X ±2° .XX ±1°
PART No. PHDXXR-H		EMILY		
DRAWING No. PHDXXR-H		CHECKED BY HZF		
		DRAWING BY YBL		
SCALE	NONE	REV.	CO	UNIT mm

NO.	REV.	REVISIONS	CHK	DATE
△	C0	NEW RELEASE	HZF	10/16/2013