

**△ SPECIFICATION**  
 Current Rating:3A AC/DC  
 Voltage Rating:250V AC/DC  
 Withstanding Voltage:800V AC/Minute  
 △ Contact Resistance:20 Milliohms Max.  
 Insulation Resistance:1000 Megohms Min.  
 Temperature Range:-25°C~+85°C  
 Pin:Brass,Tin Plated Over Nickel  
 Housing:PA66+15%G.F.(UL94V-0),Grey  
 RoHS Compliant

**△ PHD XX D - H**  
 (1) (2) (3) (4)  
 △ (1) PHD:2.0mm PHD Series  
 (2) XX:No. Of Position  
 (3) D:DIP Straight  
 (4) H:RoHS Compliant

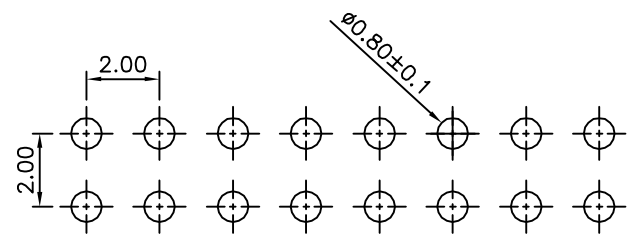
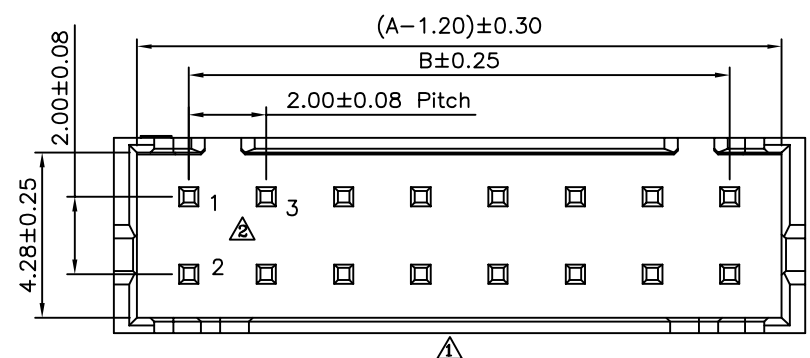
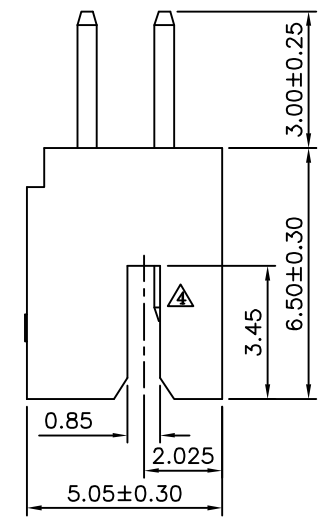
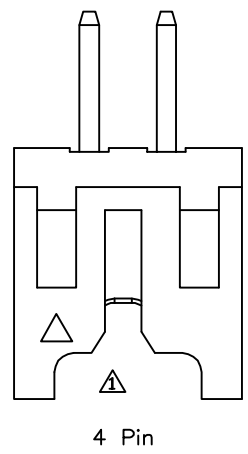
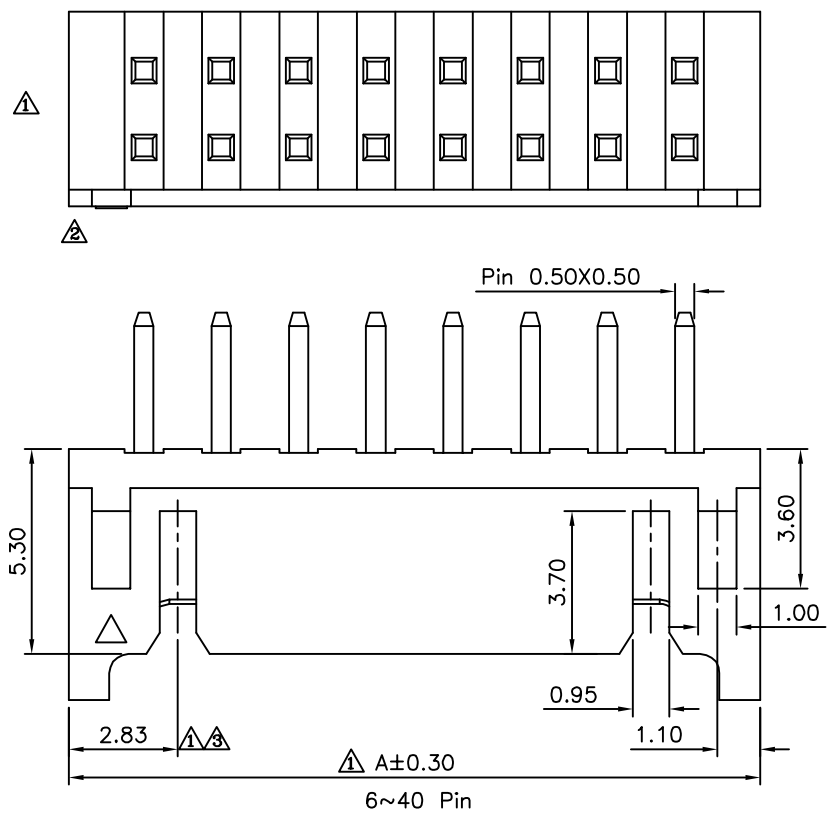

△△ Recommended P.C.B Layout(Top Side)  
 P.C.B Thickness=1.00~1.60mm(Tolerance=±0.05)

Pin	A	B
4	6.00	2.00
6	8.00	4.00
8	10.00	6.00
10	12.00	8.00
12	14.00	10.00
14	16.00	12.00
16	18.00	14.00
18	20.00	16.00
20	22.00	18.00
22	24.00	20.00
24	26.00	22.00
26	28.00	24.00
28	30.00	26.00
30	32.00	28.00
32	34.00	30.00
34	36.00	32.00
36	38.00	34.00
38	40.00	36.00
40	42.00	38.00

**AUK** A MEMBER OF AUK GROUP  
**太聯事業股份有限公司**  
**AUK CONTRACTORS CO., LTD.**

CATEGORY	APPROVED BY	UNLESS OTHERWISE SPECIFIED TOLERANCES ARE	NO.	REV.	REVISIONS	CHK	DATE
PART No. PHDXXD-H	EMILY	.X ±0.25 △	B4		Modify Data	HZF	06/17/2014
DRAWING No. PHDXXD-H	HZF	.XX ±0.20 .X* ±2°	B3		Modify Data	HZF	03/06/2013
SCALE NONE	SAN	.XXX ±0.10 .XX* ±1°	B2		Add Pin No.	HZF	09/09/2009
REV. B4			B1		Modify Data	HZF	03/25/2009
			B0		NEW RELEASE	HZF	02/24/2009