

REV.	DESCRIPTION	DRAWN	CHECKED	APPROVED
A	NEW RELEASE	YCH 01/24/08'		

NOTES:

- MATERIAL
 - INSULATOR MATERIAL:HIGH TEMPERATURE (UL 94V-0).
 - CONTACT MATERIAL:COPPER ALLOY.
- SPECIFICATION
 - TEMPERATURE:-40° to +105°C.
 - DIELECTRIC WITHSTANDING VOLTAGE:AC 500V AC.
 - INSULATION RESISTANCE:1000MΩ min.
 - CONTACT RESISTANCE:20mΩ max.
 - CURRENT RATING:3A.
- PART NUMBER: DS1023-10
- PRODUCT NUMBER CODE:
DS1023-10 - X X X X X X X X
 - POST SUPPORT
S:W/ POST
X:W/O POST
 - PACKING TYPE
T:TRAY
R:TAPE ON REEL
B:TUBE
 - PICK UP SUPPORT
S: W/
X: W/O
 - BEND TYPE
1: R1 TYPE
2: R2 TYPE
 - CONTACT PLATING
8: FULL GLOD FLASH
0: SELECTIVE GLOD FLASH
 - HOUSING COLOR
B: BLACK
 - No.of Contacts
1*1 - 1*40

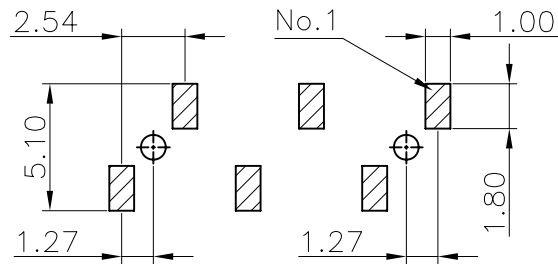
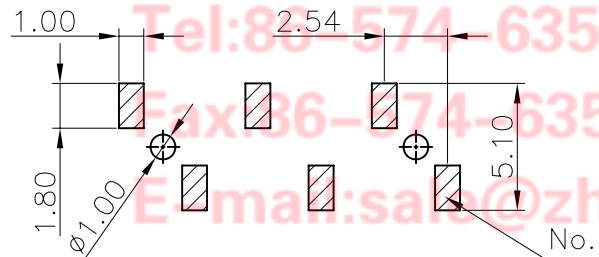
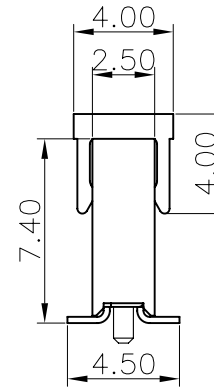
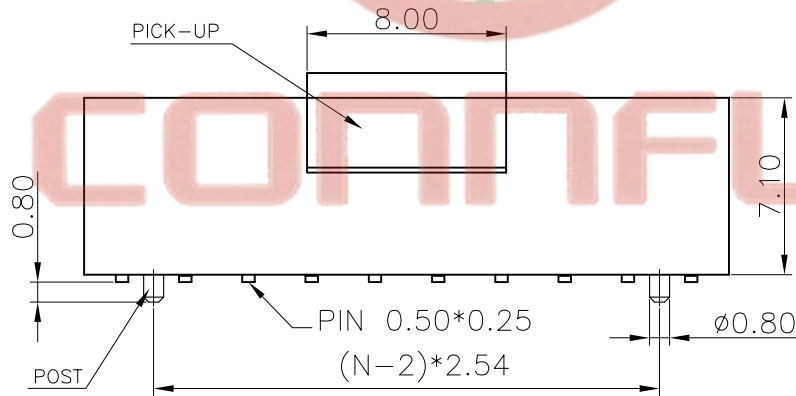
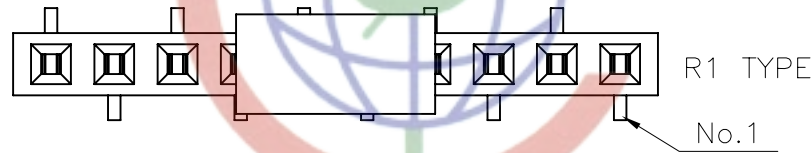
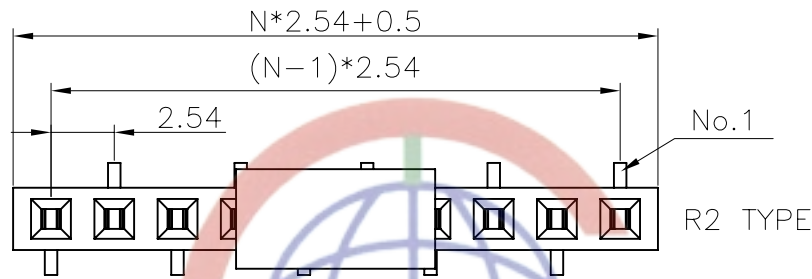

GENERAL TOLERANCE		ANGLE TOLERANCE		PROJECTION		TITLE	FEMALE HEADER PITCH
X.	±0.60	X.	±5°	UNITS	mm		2.54mm SMT TYPE H=7.1mm
.X	±0.38	.X	±3°	SHEET SIZE	A4	SERIES	DS1023-10 SERIES
.XX	±0.25	.XX	±2°				
DRAWING TYPE		CUSTOMER		晨翔电子有限公司 CONNFLY CONNFLY ELECTRONIC CO. LTD			
SCALE		1:1 SHEET 1 OF 1					
DRAWING NO.		C-DS1023-10-XXXXX					