

REV.	DESCRIPTION	DRAWN	CHECKED	APPROVED
A	NEW RELEASE	LL 23/06/05		

NOTES:

1. SPECIFICATIONS

- . Switch Function: Single Pole Single Throw
- . Contact Rating: 50mA at 12Vdc
- . Insulation Resistance: 100MΩ min.
- . Contact Resistance: 100mΩ max.
- . Operating Life: 100,00 cycles

- . Stop Strength: Place The Switch Such That Vertical, A Static Load Of 3Kgf Shall Be Applied In The Direction
- . Operation Temperature Range: -25°C to +70°C
- . Wave Soldering: Recommended Solder Temperature At 500°F(260°C)max. 5 Seconds, Subject To pcb 1.6mm Thickness.
- . Hand Soldering: Use Soldering Iron Of 30 Watts, Controlled At 608°F(320°C) Approximately 2 Seconds.

2. PRODUCT NUMBER CODE:

DS1041-01 - X X X X X X X

- Operating Life
 - 5: 50000 cycles
 - 10: 100000 cycles
- Operating force
 - 130: 130gf 160: 160gf
 - 170: 170gf 250: 250gf
- Packing type
 - A: polybag
 - B: tube
- Actuator color
 - K: black
- Housing color
 - K: black
- Profile Height(DIM. H)
 - 1: 4.3mm 2: 5.0mm 3: 7.0mm
 - 4: 7.3mm 5: 9.5mm 6: 13.0mm
 - 7: 7.5mm 8: 8.0mm 9: 8.5mm
 - 10: 12.0mm 11: 12.5mm 12: 17.0mm
 - 13: 7.8mm
- Size
 - 1: 6mm*6mm

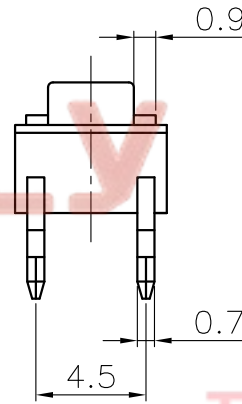
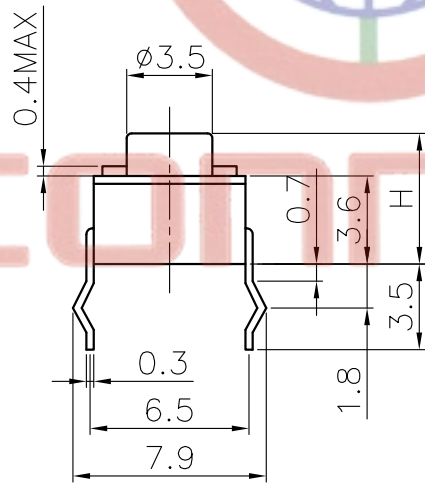

Circuit

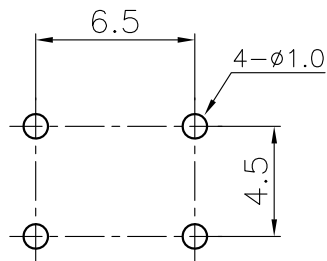
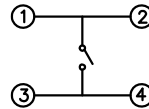

Recommend PCB layout
Tolerance ±0.05

GENERAL TOLERANCE		ANGLE TOLERANCE		PROJECTION		TITLE	TACT SWITCH DIP TYPE 6mmX6mm
X.	±0.60	X.	±5°	UNITS	mm	SHEET	DS1041-01
.X	±0.38	.X	±3°	SHEET SIZE	A4	SERIES	DS1041-01
.XX	±0.25	.XX	±2°	DRAWING TYPE			
DRAWING TYPE		CUSTOMER		SCALE			
SCALE		1:1	SHEET	1 OF 1			
DRAWING NO.		C-DS1041-01-1XXXXXX		DRAWING NO.			



晨翔电子有限公司

CONNFLY CONNFLY ELECTRONIC CO. LTD

Tel: 86-574-63508787

Fax: 86-574-63510811

E-mail: sale@zhenqi.com.cn

Http://www.connfly.com

Add: East Industry Zone, KuangYan Town, Xi Ningbo City, Zhejiang Province, China

NOTES:

1. SPECIFICATIONS

- . Switch Function: Single Pole Single Throw
- . Contact Rating: 50mA at 12Vdc
- . Insulation Resistance:100MΩ min.
- . Contact Resistance:100mΩ max.
- . Operating Life:100,00 cycles

REV.	DESCRIPTION	DRAWN	CHECKED	APPROVED
A	NEW RELEASE	LL 12/15/06		

- . Stop Strength: Place The Switch Such That Vertical, A Static Load Of 3Kgf Shall Be Applied In The Direction
- . Operation Temperature Range: -25°C to +70°C
- . Wave Soldering: Recommended Solder Temperature At 500°F(260°C)max. 5 Seconds,Subject To pcb 1.6mm Thickness.
- . Hand Soldering: Use Soldering Iron Of 30 Watts,Controlled At 608°F(320°C)Approximately 2 Seconds.

2. PRODUCT NUMBER CODE:

DS1041-01 -	X	X	X	X	X	X	
							Operating Life
							5: 50000 cycles
							10: 100000 cycles
							Operating force
							130: 130gf 160: 160gf
							170: 170gf 250: 250gf
							Packing type
							A: polybag
							B: tube
							Actuator color
							K: black
							Housing color
							K: black
							Profile Height(DIM. H)
							1:4.3mm 2:5.0mm 3:7.0mm
							4:7.3mm 5:9.5mm 6:13.0mm
							7:7.5mm 8:8.0mm 9:8.5mm
							10:12.0mm 11:12.5mm 12:17.0mm
							13:7.8mm
							Size
							2: 3mm*6mm

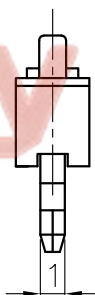
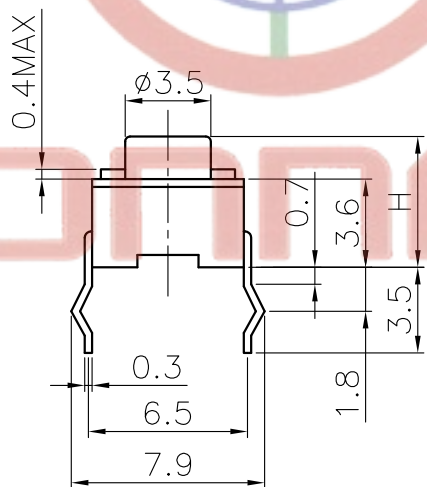

Circuit

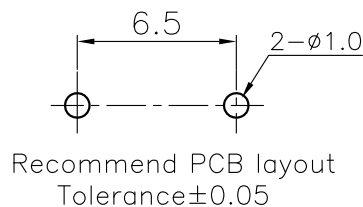
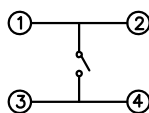

GENERAL TOLERANCE		ANGLE TOLERANCE		PROJECTION		TITLE
X.	±0.60	X.	±5°	UNITS	mm	TACT SWITCH DIP TYPE 3mmX6mm
.X	±0.38	.X	±3°	SHEET SIZE	A4	SERIES DS1041-01
.XX	±0.25	.XX	±2°	DRAWING TYPE CUSTOMER		
DRAWING TYPE		CUSTOMER		SCALE 1:1 SHEET 1 OF 1		
DRAWING NO.		C-DS1041-01-2XXXXXX		DRAWING NO.		



晨翔电子有限公司

CONNFLY CONNFLY ELECTRONIC CO. LTD

Tel:86-574-63508787
 Fax:86-574-63510887
 E-mail:sale@zhennan.com
 Http://www.connfly.com
 Add: East Industry Zone, KuangYan Town, Sixiangba China