

REV.	DESCRIPTION	DRAWN	CHECKED	APPROVED
A	NEW RELEASE	LJH 05/09/05'		

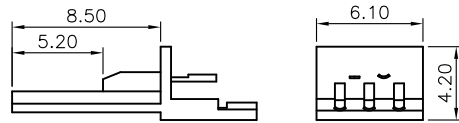

Housing with contact

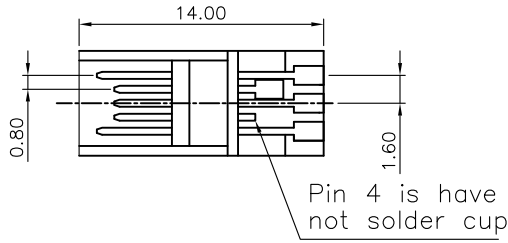
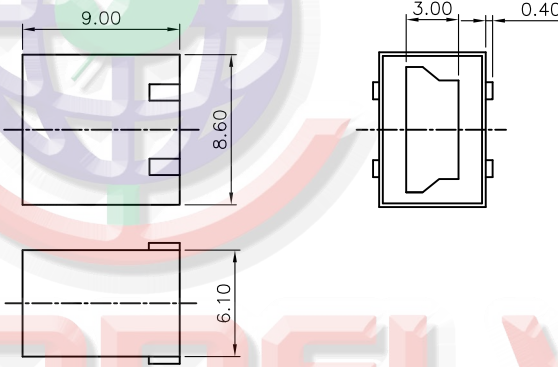

Hood

NOTES:

1.SPECIFICATIONS

- .CURRENT RATING: 0.5A/pin Max.
- .VOLTAGE RATING: 30V(DC)
- .DIELECTRIC WITHSTANDING VOLTAGE: 100VAC 1 minute.
- .CONTACT RESISTANCE: 50mΩ Max.
- .INSULATION RESISTANCE: 100MΩ Min
- .TEMPERATURE RANGE: -40°C+105°C

2.MATERIALS

- .HOUSING: PBT.
- .HOOD: ABS.
- .SHELL: STEEL
- .CONTACT: COPPER ALLOY

3.PRODUCT NUMBER CODE:

DS1105-01 - X X X X

- Contact plating
- 0: Selective gold flash
- C: Selective 3u" gold
- 3: Selective 30u" gold

- Shell plating
- 6: Tin
- N: Nickel
- 8: Full gold

- Color of Hood
- B: BLACK

- Color of housing
- B: BLACK
- Products series
- DS1105-01

Tel:86-574-63508787

Fax:86-574-63510817

E-mail:sale@connfly.com

http://www.connfly.com

Add:East Industry Zone Kung Yan

Town Cixi Ningbo China

P.C:315333

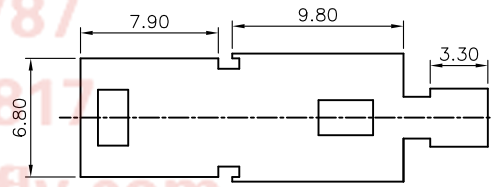
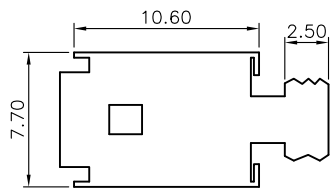

Down shell

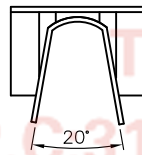
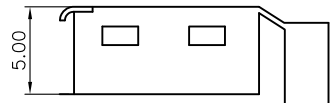

Upper shell

GENERAL TOLERANCE		ANGLE TOLERANCE		PROJECTION	TITLE
X.	±0.60	X.	±5°	mm	MINI USB 5PIN B TYPE MALE SOLDER
.X	±0.38	.X	±3°	A4	SERIES DS1105-01 SERIES
.XX	±0.25	.XX	±2°		
DRAWING TYPE		CUSTOMER		晨翔电子有限公司 CONNFLY CONNFLY ELECTRONIC CO. LTD	
SCALE		SHEET			
DRAWING NO.		1 OF 1			
		C-DS1105-01-XXX			